

## QUICK GUIDE FOR CONNECTING SEITRON SMART FAMILY DEVICES TO GOOGLE HOME

### What you need:

- Seitron IoT programmable thermostats.
- Google Nest or Google Home assistant.
- Smartphone or tablet with Android or iOS operative system.
- App Seitron Smart connected to Seitron IoT programmable thermostats.
- Google home  App.

**WARNING!** Before doing the steps below, make sure your Google assistant is up and running and connected to the Wi-Fi network.

Install the latest version of the Google Home  application and perform the following procedure:

1. Press the '+' icon at the top left of the screen:

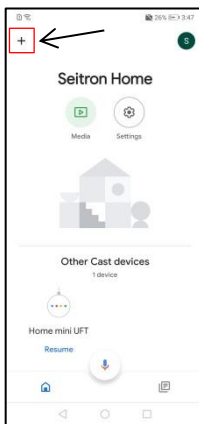

2. Select "Set device".

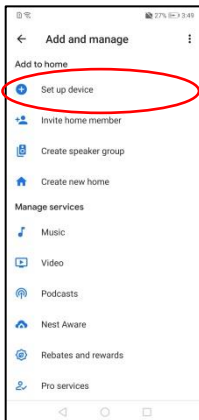

3. Select "Have you already set something?".

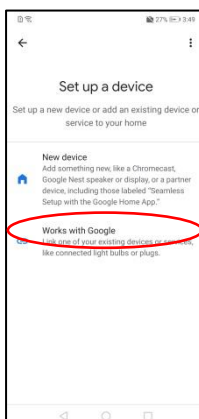

4. Select "Seitron Smart", optionally using the search bar at the top.

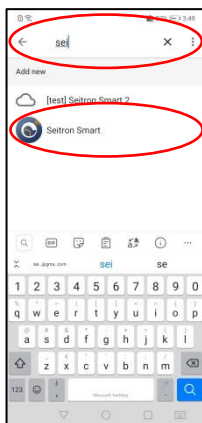

5. Sign in to your Google account to add your selected device.

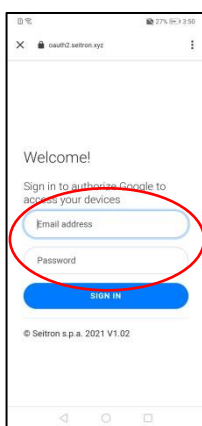

6. Wait for the accounts to be connected.



7. Select the devices you want to add to the room.

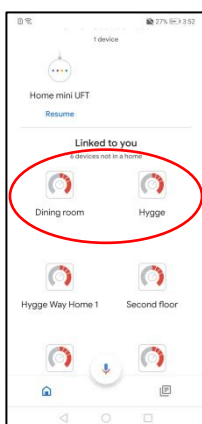

8. Once the devices are added to the room, the screen that will appear will be similar to that of the following example.

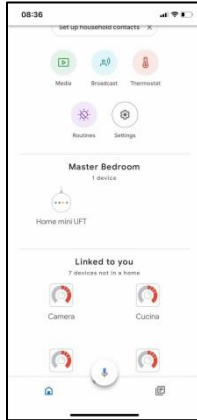

9. By selecting one of the connected devices, it will then be possible to set and display its properties.



Now the programmable thermostats are connected: available commands for the 'office' programmable thermostat:

- OK Google, what's the temperature?
- OK Google, what's the temperature in the office?
- OK Google, on what mode are the programmable thermostat on?
- OK Google, on what mode is office on?
- OK Google, set office to cooling mode.
- OK Google, set office to heating mode.
- OK Google, set gas to 21.
- OK Google, lower the office temperature.
- OK Google, raise the office temperature.
- Ok Google, It's cold in the office.