

## Clock setting

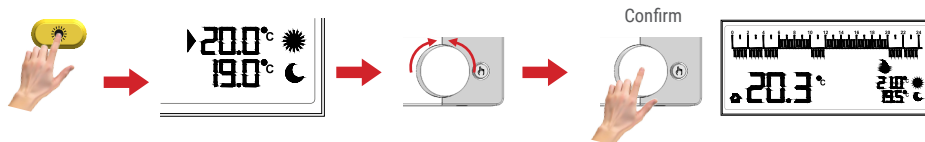

## Setting the set point temperature

### Comfort temperature setting



### Economy temperature setting

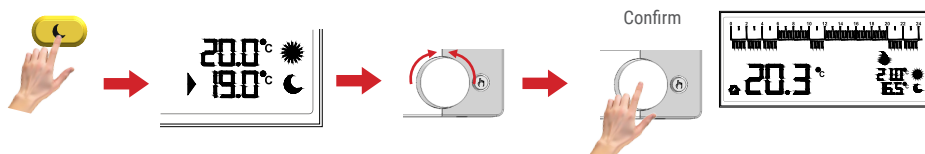

## Time program setting

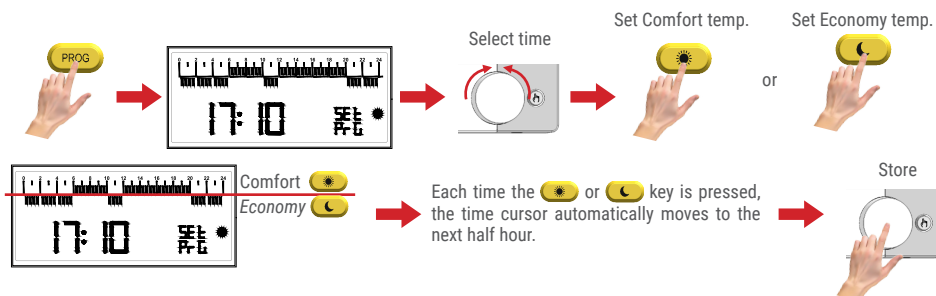

## WARRANTY

Regarding the continuous development of its products, the manufacturer reserves the right to make changes in technical data and performance without prior notice. The consumer is guaranteed against product conformity defects according to European Directive 2019/771 EU as well as the manufacturer's warranty policy document. The full text of the warranty is available from the seller upon request.

WIST03300ESE 041284 050523

## Kit freetime evo radio

### Wireless programmable thermostat kit



**CONTACT US**  
customer.care@seitron.it

**TALK WITH US**  
+39 0424 567842



To download the complete manual,  
scan this QR code



To view the video tutorials,  
scan this QR code



### WARNING!

THE DEVICES IN THIS KIT HAVE BEEN FACTORY PRE-MATCHED: ONCE THE MECHANICAL INSTALLATION IS DONE, THEY ARE READY FOR USE.

## radio RECEIVER

### TECHNICAL FEATURES

Power supply:	230V~ 50Hz/ 24V~	Thermoregulation class:	IV (2%)
Outputs:	6(4)A 250V~ (voltage free contacts)	Software class:	A
Type of action:	1	Ball pressure test temperature:	75°C
Pollution degree:	2	Rated impulse voltage:	2500V
EMC test voltage:	230V~ 50 Hz	Size:	78x125x30,5 mm (LxAxP)
EMC test current:	45mA		

### INSTALLATION

#### WARNING!

- Before wiring the appliance be sure to turn the mains power off.
- Before proceeding with the installation of the receiver, make sure that the radio signals transmitted by the thermostats are correctly received by the receiver.
- Installation and electrical wirings of this appliance must be made by qualified technicians and in compliance with the current standards.

- 1 Cut off mains power.



- 2 Using a screwdriver, push the plastic flap of the bottom slot and slightly lift the cable lid up.

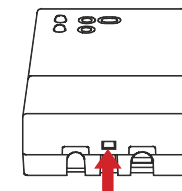

Fig. 1

- 3 Rotate the cable lid and remove it completely.

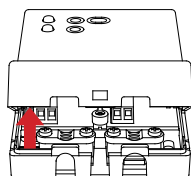

Fig. 2

4

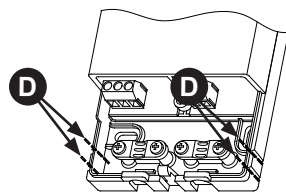

Fig. 3

There are three options for the cable entry:

**Back cable entry:** Open the hole E Fig. 4, with a screwdriver.

**Side cable entry:** By using suitable pliers, remove the plastic teeth, as indicated by arrows in D Fig. 3.

**Bottom cable entry:** Open one or both holes F Fig. 4, with a screwdriver.

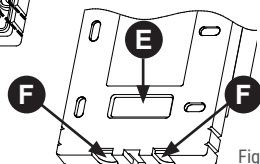

Fig. 4

5

Fix the plate onto the wall using the two screws housings with a 60 mm centre-to-centre distance (use the screws and/or dowels supplied) - Fig. 5.

### WARNING!

The receiver must be installed on a wall or on a surface in order to make the back of the product inaccessible.

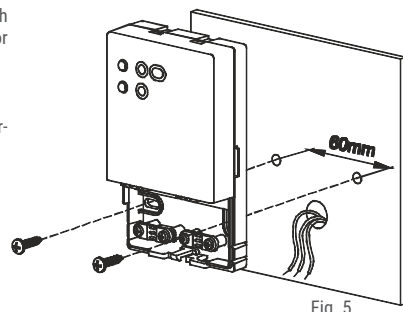

Fig. 5

6

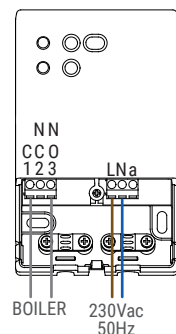

Fig. 6

Make electrical connections following the "Electrical Connections" chapter of the complete manual.

A simplified connection diagram is shown on the side:

Power supply:

L N: Power supply 230V ~ 50Hz (Neutral on terminal N)

Relay contacts:

NO: Normally open contact

NC: Normally closed contact

C: Common

7

Place the cable lid on the base and rotate it towards the base; push the cable lid until the locking plastic flap springs into the hole on the lower side of the cable lid (Fig. 1).

8

Power the receiver back on.



## PROGRAMMABLE THERMOSTAT freetime evo radio

### TECHNICAL FEATURES

Power supply:

Battery 2x1.5V  $\text{---}$  size AA.

Software class:

A

Size:

134x86x36 mm (LxHxD)

Thermoregulation class:

IV (2%)

### INSTALLATION

1

Cut off mains power.



2

Unhook and remove the front cover of **freetime evo radio**, from its plastic base underneath, applying pressure on the 2 clips located on the bottom side of **freetime evo radio** and lifting the cover towards the upper side.

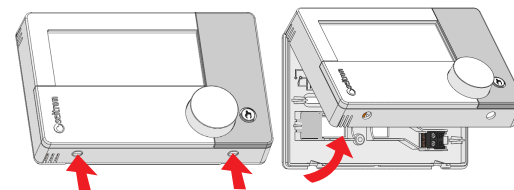

3

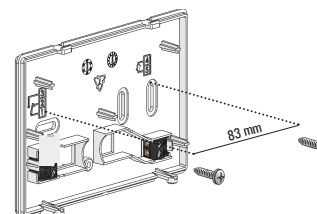

Fix the base of **freetime evo radio** to the wall using the provided screws, taking care to pass the wires through the special openings.

4

Connect the remote temperature probe (Optional).

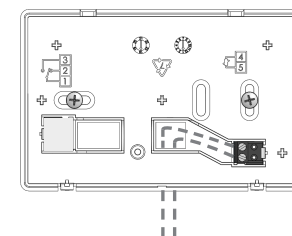

5

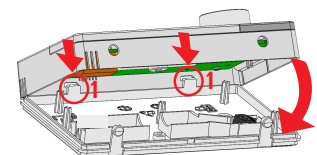

Place back the plastic case of **freetime evo radio** by first hooking it to the upper side of the plastic base (1) and then locking it to the lower side clips (2).

6

Access the battery compartment, by sliding towards left the cover. Fix **freetime evo radio** body to the base using the provided screw that has its dedicated hole inside the battery compartment.

7

Insert the batteries in the battery compartment, respecting polarities.

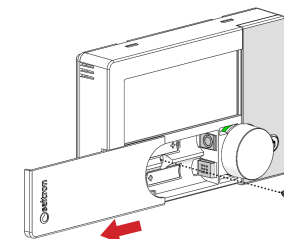

8

Set the main parameters in order to operate **freetime evo radio** (Time - Temperature - Schedule Program).